

### Installation Instructions

#### Description

The drain accessory kit provides a contained length of tubing under the unit. The drain pan can be moved, without being disconnected, to allow access to the front panel screws.

- P/N 01535335 (Does not include 4" legs)
- P/N 01535343 (Contains 4" legs - required for Countertop (CI) units)

If you experience any problems during the installation of this kit, please call Follett Technical Service toll-free at (877) 612-5086 or +1 (610) 252-7301 for assistance.

#### Materials Supplied

- (1) Pan, hose support
- (4) Screw, phillips 10-16 x 3/8
- (1) Clamp, hose
- (10') Tubing
- (1) Cover, hose support
- (4) Screw, phillips, M5 x 12
- (1) Angle bracket, hose support
- (2) Clamp, nylon
- (1.125") Edge protector
- (4) 4" legs - Included only with P/N 01535343

#### Installation



#### CAUTION!

*Except for routine cleaning and sanitizing, only qualified technicians should attempt to service or maintain this equipment.*

1. Drill 11/32" hole through drain nipple (**Fig. 1**).

**Fig. 1**

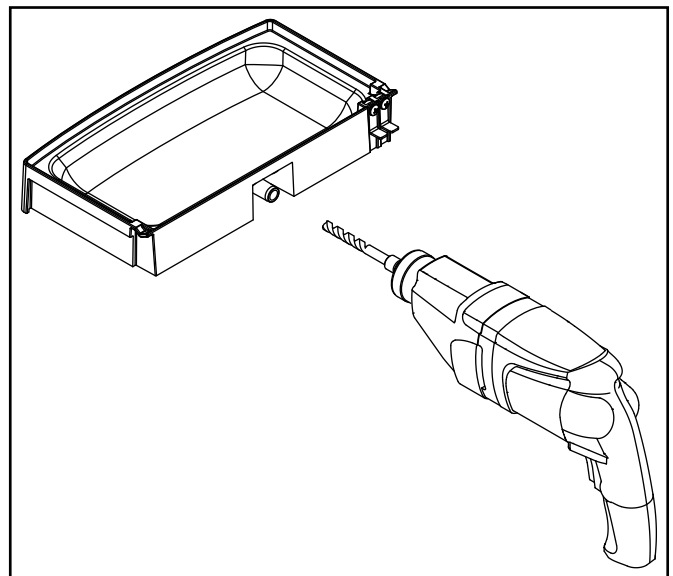

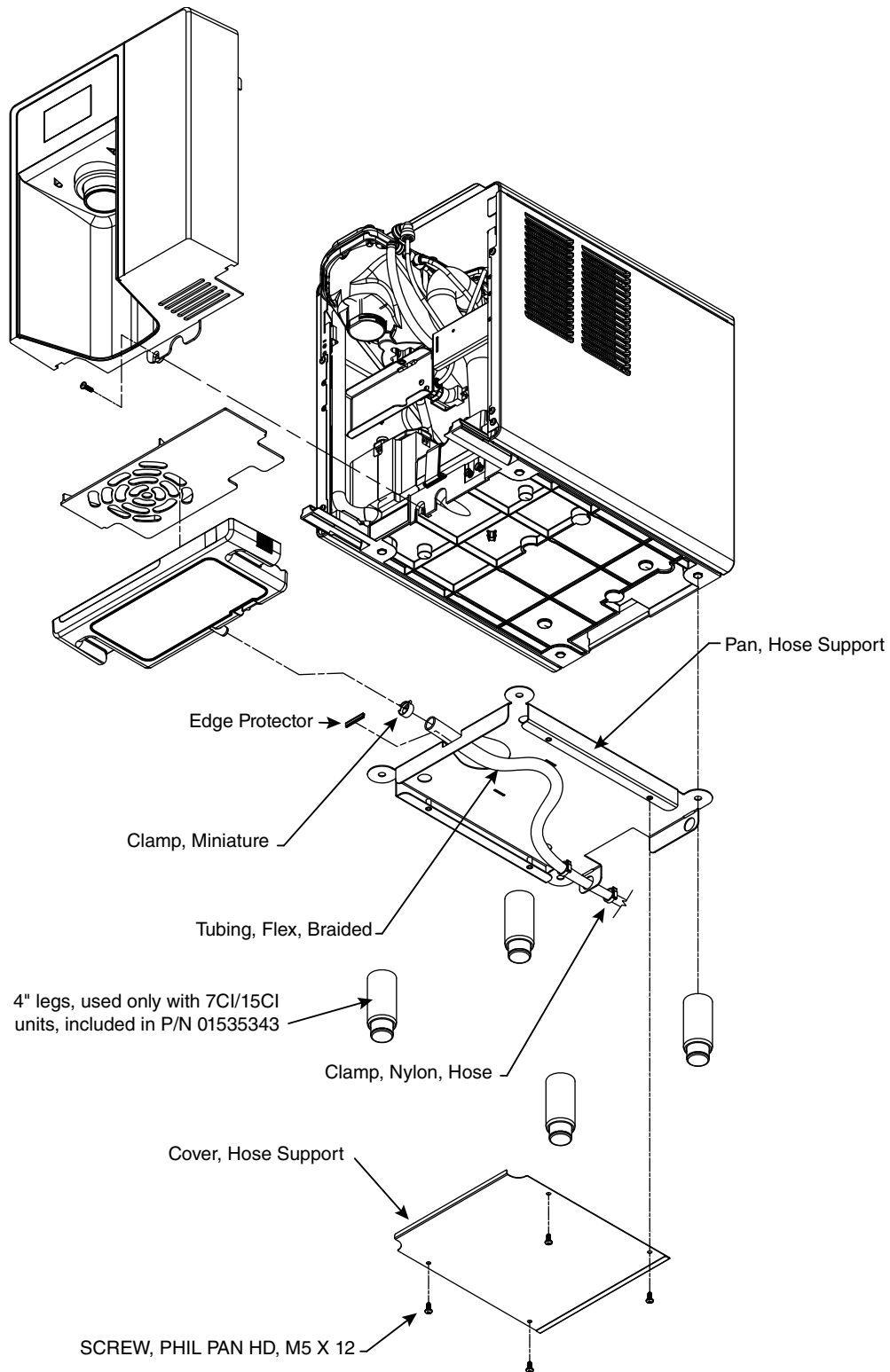

**Notes:**

- Use nylon clamps to capture 25.5" (65 cm) of drain tube inside the machine. Connect remainder of tube to drain according to local code.
- The angle bracket and 4" legs are used only for countertop units.

Follett is a registered trademark of Follett Products, LLC, registered in US.  
 Champion is a trademark of Follett Products, LLC, registered in US.



801 Church Lane • Easton, PA 18040, USA  
 Toll free (877) 612-5086 • +1 (610) 252-7301  
 www.follettice.com

01557370R00  
 © Follett Products, LLC 8/24